

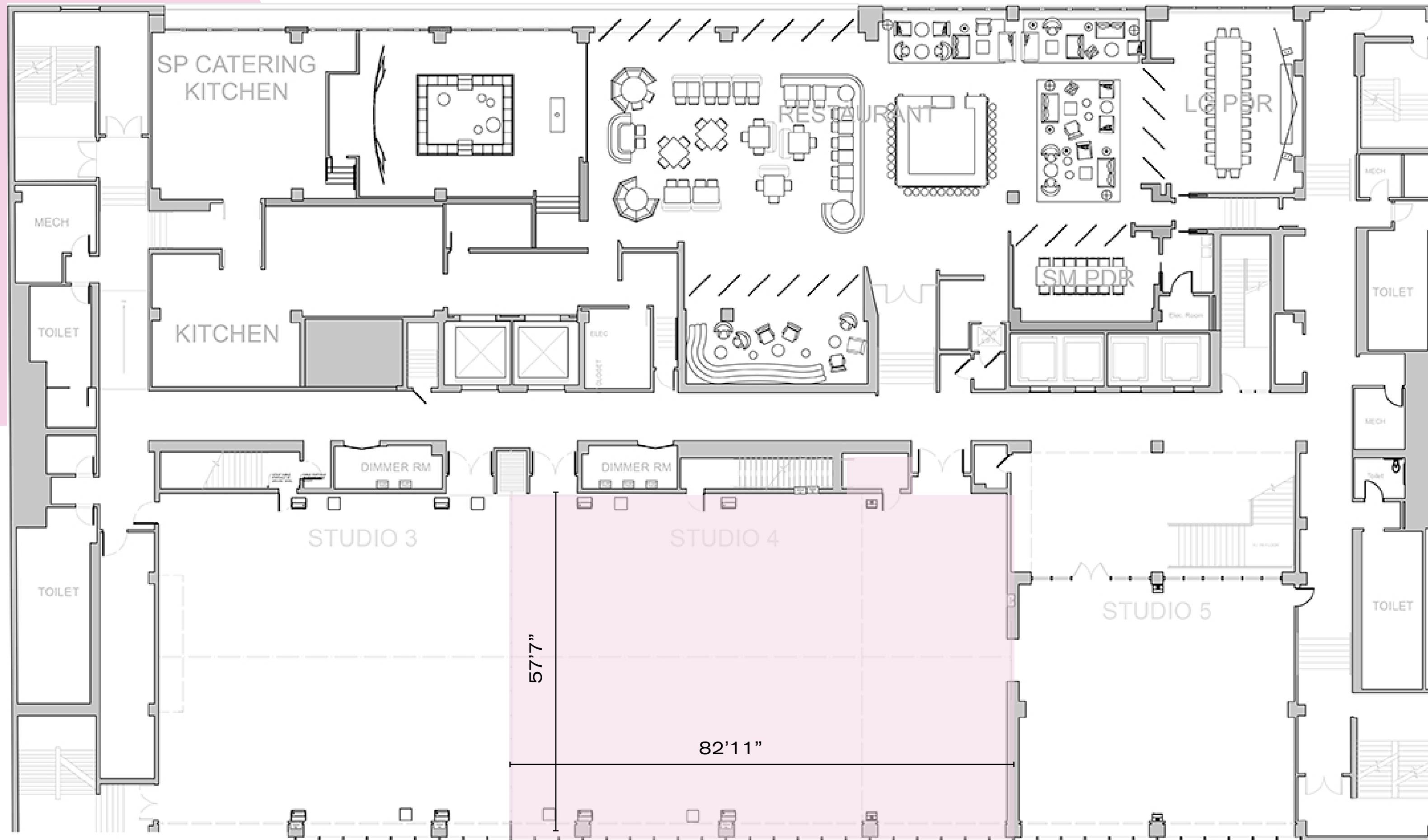

# Studio 4

**6TH FLOOR**





**SIZE**

4,800 Ft<sup>2</sup> Open Floor  
66 Ft<sup>2</sup> Storage Space

**CAPACITY**

350 Max Occupancy

**SPECIFICATIONS**

- 30' Ceilings
- Motorized Truss and Beams
- Floor to Ceiling Blackout Windows
- West-Facing Views
- Concrete Floors
- Built-in Sound System
- 3-Phase Camlock Power
- Access to Studio 5
- Stairs to South Mezzanine

